

Biosecurity in the Food and Feed Chain

Animal By Product Regulations in relation to
Composting and Anaerobic Digestion

8th June 2015

Justin Byrne Veterinary Inspector DAFM

Overview

- Animal By Products (ABP)
- Composting/Biogas

What is ABP

- Animal By Product is defined under EU regulation as “bodies or parts of animals or products of animal origin.....not intended for human consumption”
- Risk categorisation

Examples of ABP

- Category 1 – brain, spinal cord (for disposal only)
- Category 2 – fallen animals, manure, contaminated milk (not for human consumption)
- Category 3 – catering waste, former foodstuffs, milk, eggs

Why regulate use of ABP

- Disease control (BSE, FMD etc.)
- Avoid contamination of food chain
- Avoid contamination of feed chain
- Protect “brand Ireland”
- Protect farming industry, esp beef

Category 3

- **Catering waste** – all waste food including used cooking oil originating in restaurants, catering facilities and kitchens, including central and household kitchens (not international)
- **Former foodstuffs** – containing products of animal origin no longer intended for human consumption for commercial reasons or due to problems of manufacturing or packaging defects from which no risk to public or animal health arises

ABP regulations

- EU1069/2009 – ABP and derived products
- EU142/2011 – implementing regulation
- SI187/2014 – ABP regulation

ABP regulations

- Collection
- Transport
- Storage
- Handling
- Processing
- Use and disposal

To prevent these products presenting a risk to
animal or public health

Composting/Biogas

- Composting – ABP are at least part of the material subjected to biological degradation under **AEROBIC** conditions.
- Biogas – ABP are at least part of the material subjected to biological degradation under **ANAEROBIC** conditions.



Plant Approval and Validation

- Application – 1st stage approval in principle
- Validation – conditional approval
- Approval

ABP Regulation Requirements

- HACCP
- Biosecurity, plant structure, hygiene, transport
- Intake
- Processing/transformation
- Storage, dispatch, traceability







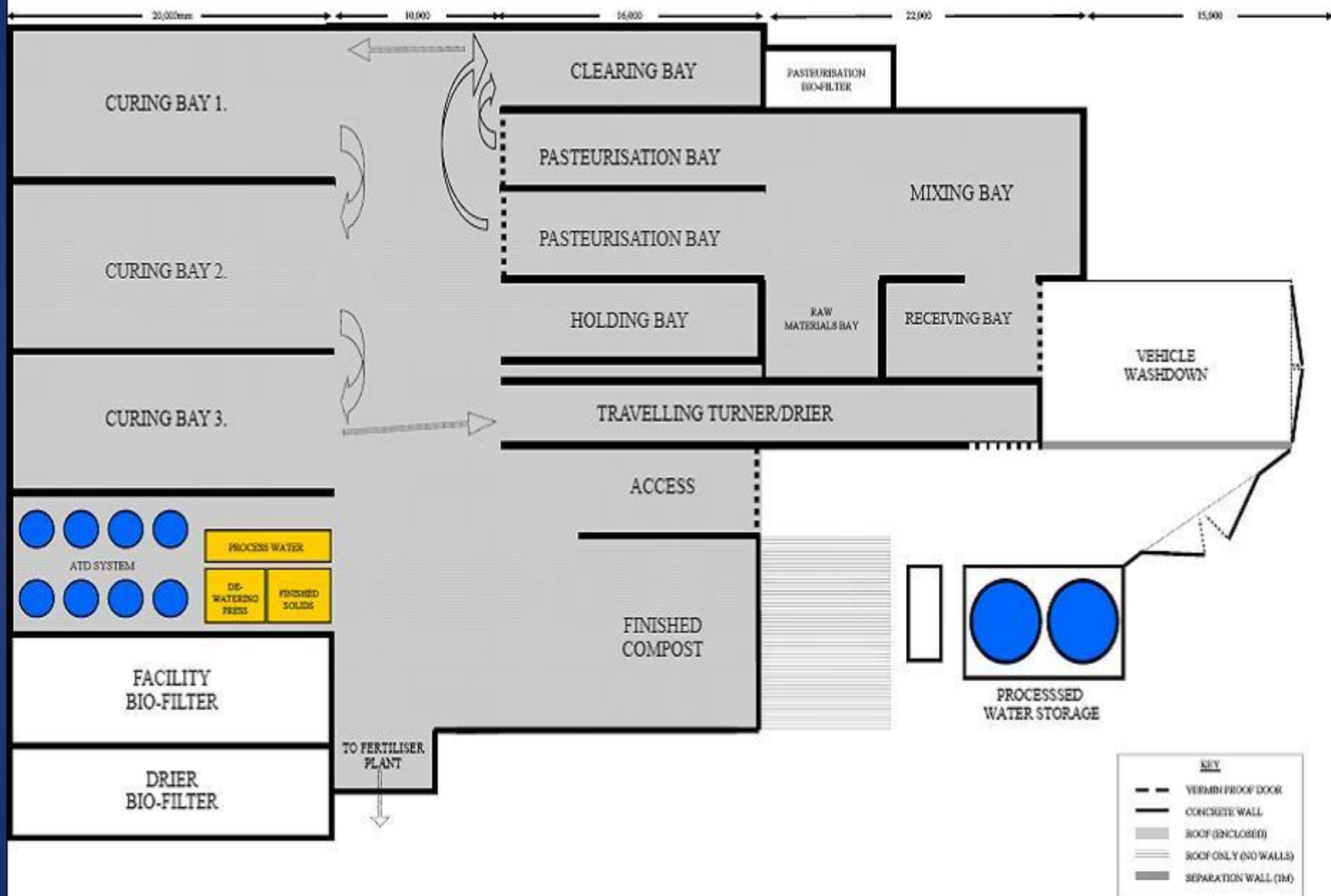

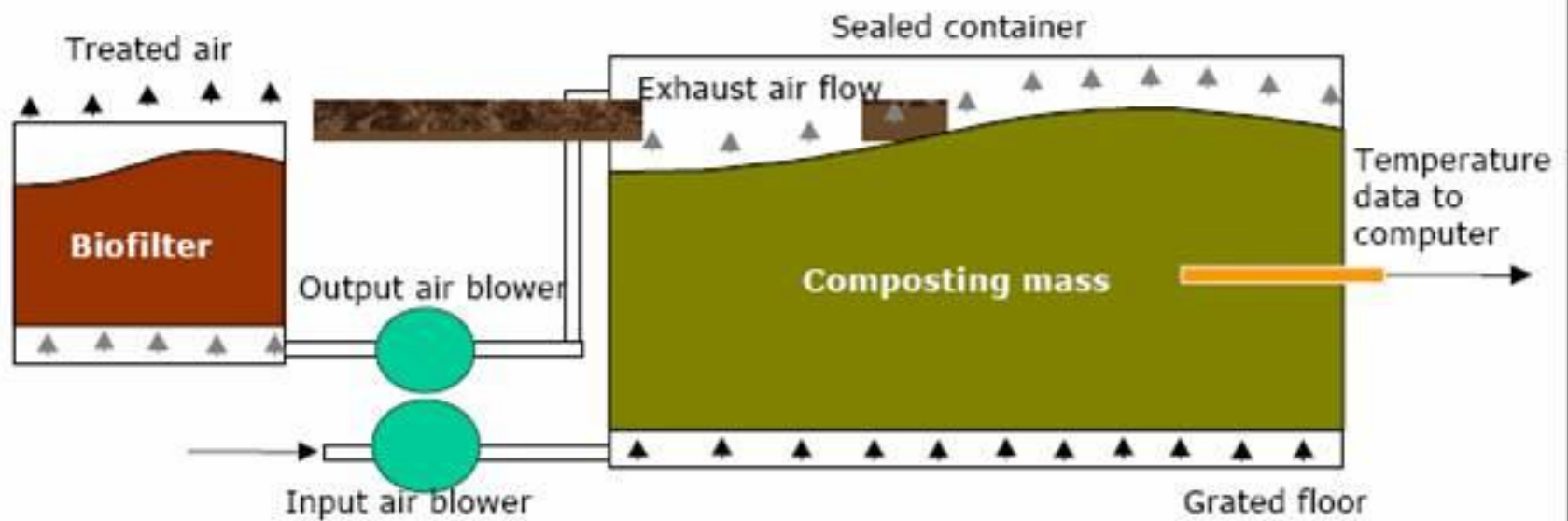

Internal features of CCS In-vessel reactor illustrating the air-flow





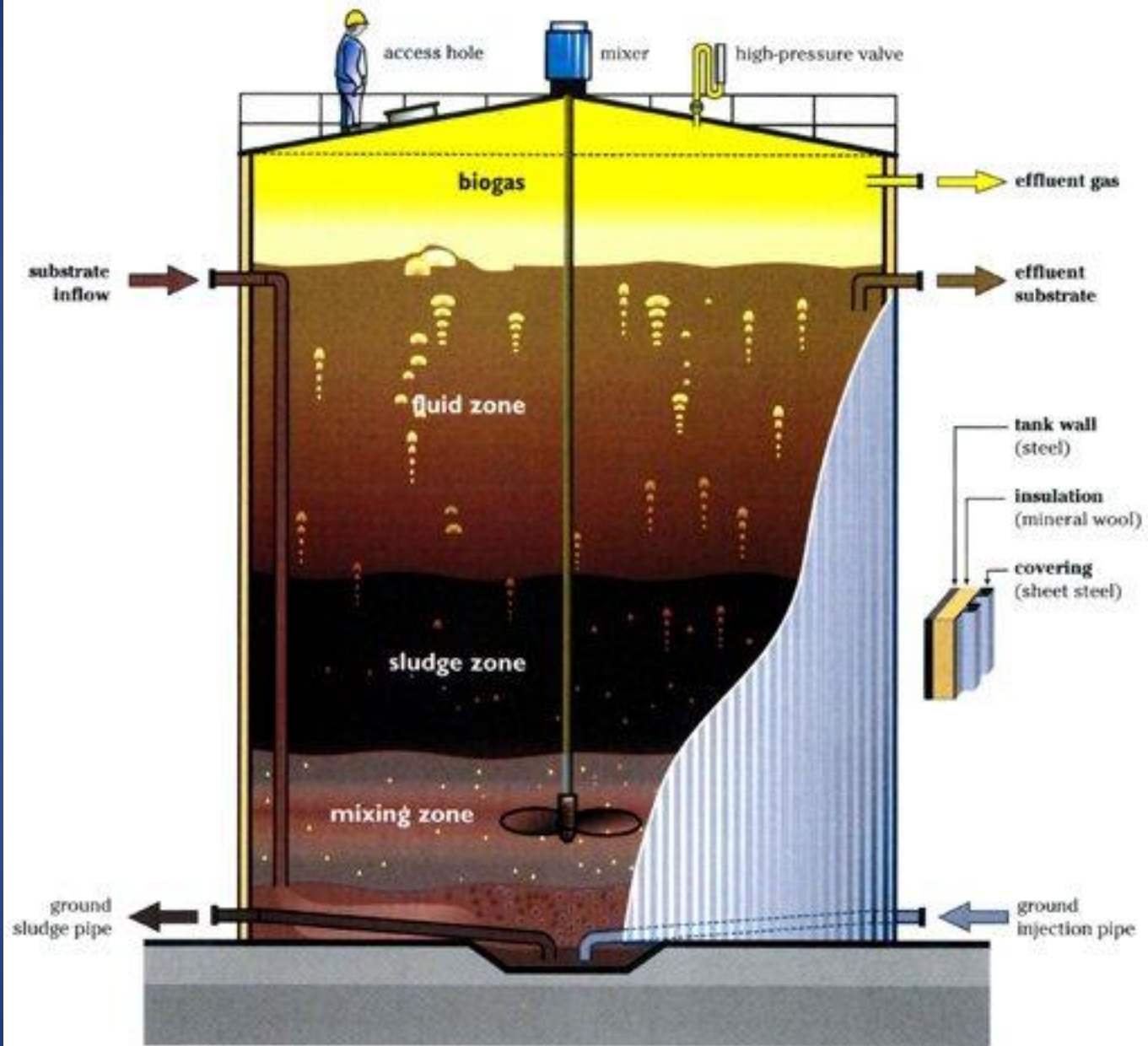





Transformation Standard

- EU standard – 70 degrees C, 60 mins, 12mm (type 1), all permitted feedstocks
- National standard – 60 degrees C, 48hrs twice, 400mm max (type 2) feedstocks permitted are catering waste, manure, milk, digestive tract content
- Alternative standard

Microbiological testing

- E. Coli sampling during or immediately after processing parameters are achieved
- Salmonella
- 5 samples

Organic Fertilizers/Soil Improvers

- If farmed animals present, grazing restrictions and herbage usage apply and end user must be registered with DAFM
- If no farmed animals present (tillage, landscapers), no registration required

Thank you for your attention

